

HONDA CBR1000RR FIREBLADE / SP '20-

MOUNTING INSTRUCTIONS VIDEO

REF 20508

FRONTAL GP SPOILER / ALERON FRONTAL GP



1 Person



15 min



EASY

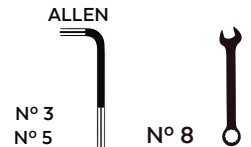

ID.	PIEZA/PART	DESCRIPCIÓN	DESCRIPTION	QTY.	REF.:
1		Base alerón (ABS)	Main spoiler (ABS)	1	10850JM3
2		Soporte metálico	Metal support	1	SOPORIP3--20508
3		Pieza soporte alerón (Tamaño pequeño)	Spoiler support piece (small size)	2	SOPOR-I---20431
4		Deflector derecho	Right deflector	1	10851A/N/RM3
5		Deflector izquierdo	Left deflector	1	10851A/N/RM3
6		Tapon tornillo M5 ISO7380	M5 ISO7380 screw cap	8	TAPON-----85
7		Tornillo allen M5x30 Ø11 ISO 7380	M5x30 Ø11 ISO 7380 allen screw	4	TORNI-I7380-767
8		Casquillo Ø13xØ8,5x9mm	Ø13xØ8,5x9mm arrowhead	4	CASQUI-----777
9		Tornillo M5x16 Ø11 ISO7380 (negro)	M5x16 Ø11 ISO7380 screw (black)	4	TORNI-I7380-493
10		Tornillo M5x11 ISO7380 (Negro)	M5x11 ISO7380 screw (black)	4	TORNI-AI-----520
11		Tuerca autoblocante M5	M5 lock Nut	4	TUERCA-D982-745
12		Arandela de goma Ø4,5xØ11x2mm	Ø4,5xØ11x2mm rubber washer	8	ARAND-EPDM--722
13		Tope de goma Ø3,7-3,8x3,2mm	Ø3,7-3,8x3,2mm bumper foot	4	TOPE--POF-40022
14		Arandela de nylon M5	M5 nylon washer	12	ARNV0000000245
15		Plantilla	Template	1	PLANT-----20508
16		Cinta auto-adhesiva de doble cara 3M, Tamaño pequeño. (Se suministra montado con ID 3)	3M double-sided self-adhesive tape, small size. (Supplied already mounted on ID 3)	2	ADHESI3M--94X23

* Algunos componentes se suministran montados.
Some components are supplied assembled.

HONDA CBR1000RR FIREBLADE / SP '20-

INSTRUCCIONES DE MONTAJE - MOUNTING INSTRUCTIONS - MONTAGEANLEITUNG

1

**DISASSEMBLY
DESMONTAJE**

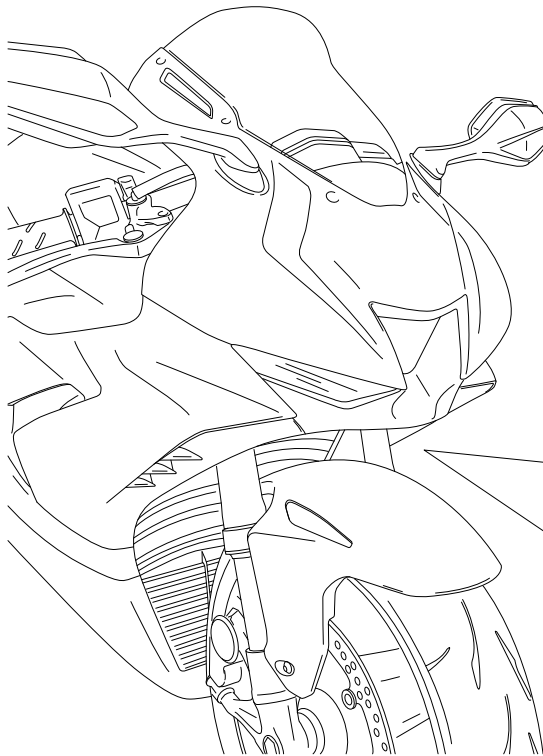

A Tornillo original
Original screw

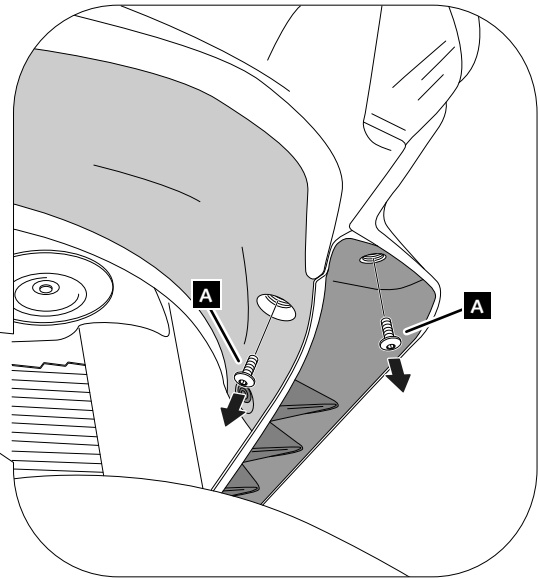

2

**ASSEMBLY
MONTAJE**

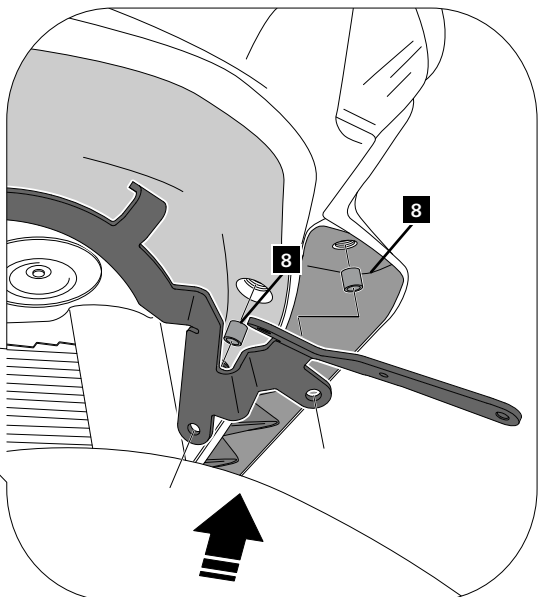
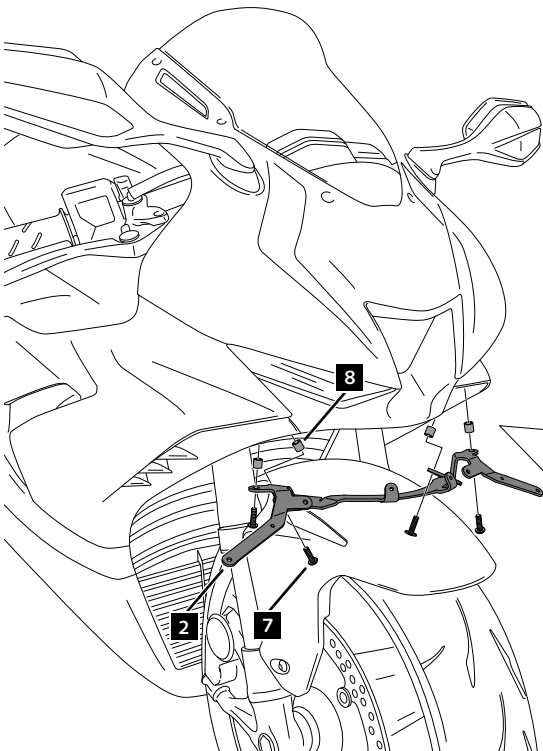

HONDA CBR1000RR FIREBLADE / SP '20-

INSTRUCCIONES DE MONTAJE - MOUNTING INSTRUCTIONS - MONTAGEANLEITUNG

3

ASSEMBLY
MONTAJE

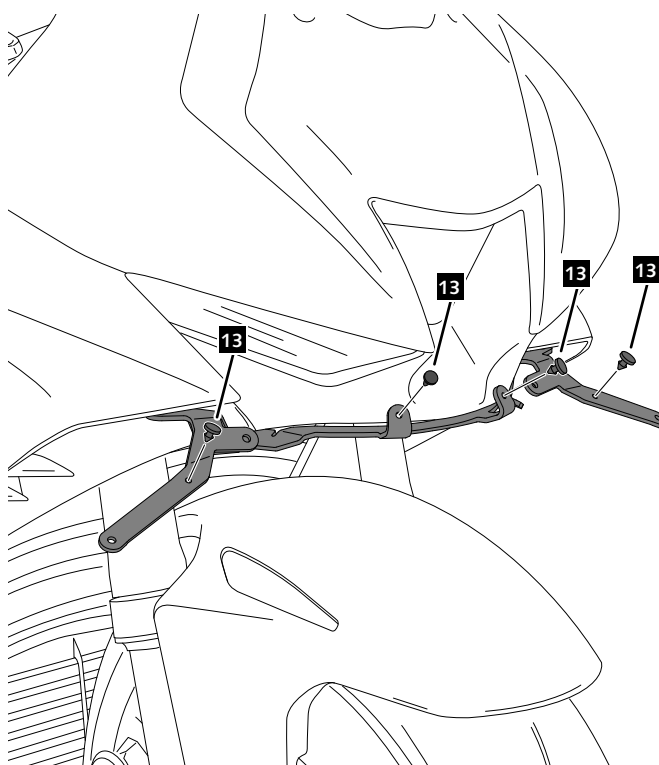

4

ASSEMBLY
MONTAJE

Se muestra el montaje del lado derecho a modo de ejemplo, realizar los mismos pasos para el montaje del lado izquierdo.
The right side assembly is shown as an example, so the same steps can be performed for the left side assembly.

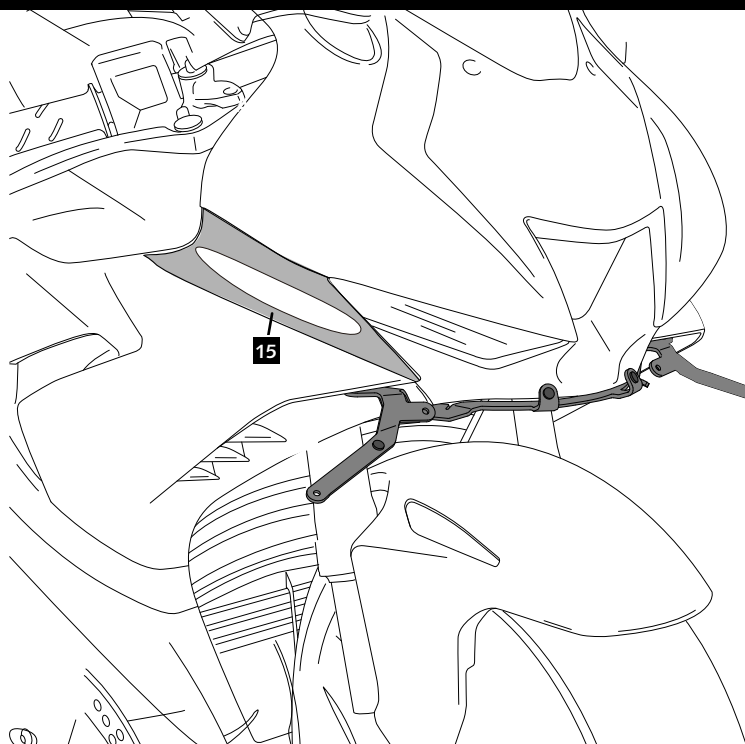

HONDA CBR1000RR FIREBLADE / SP '20-

INSTRUCCIONES DE MONTAJE - MOUNTING INSTRUCTIONS - MONTAGEANLEITUNG

5

Se muestra el montaje del lado derecho a modo de ejemplo, realizar los mismos pasos para el montaje del lado izquierdo.
The right side assembly is shown as an example, so the same steps can be performed for the left side assembly.

ASSEMBLY
MONTAJE

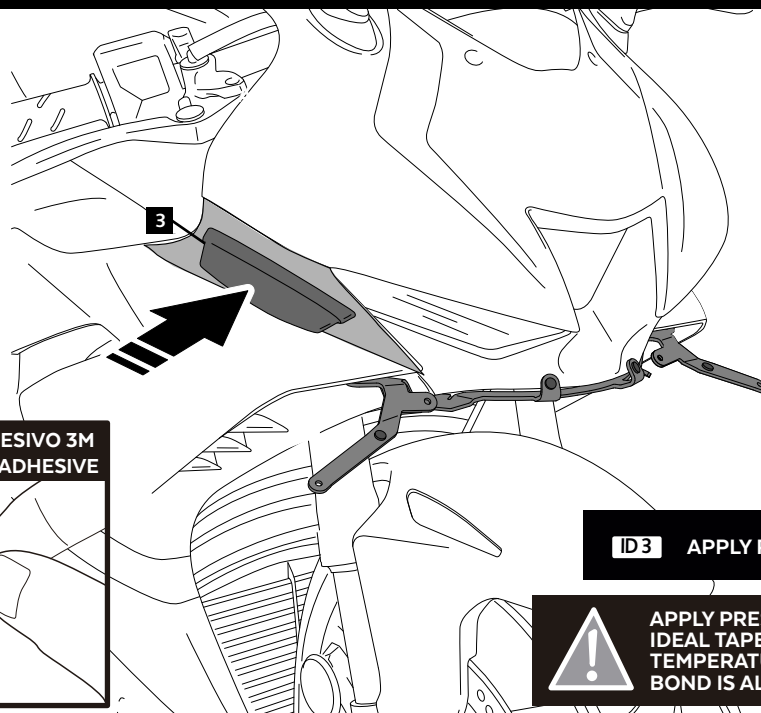

5.1 EXTRAER PAPEL DEL ADHESIVO 3M
REMOVE PAPER FROM 3M ADHESIVE

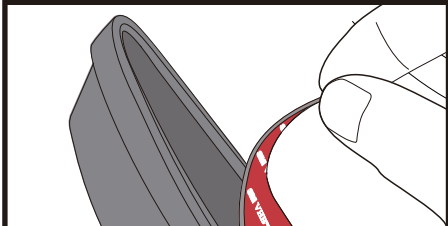

ID3 APPLY PRESSURE ON PIECES SPOILER SUPPORT



APPLY PRESSURE ON ADHESIVE AREA FOR 1 MINUT.
IDEAL TAPE APPLICATION IS ACCOMPLISHED WHEN
TEMPERATURE IS BETWEEN 21 °C and 38 °C AND THE
BOND IS ALLOWED TO DWELL 24 HOURS.

6

ASSEMBLY
MONTAJE

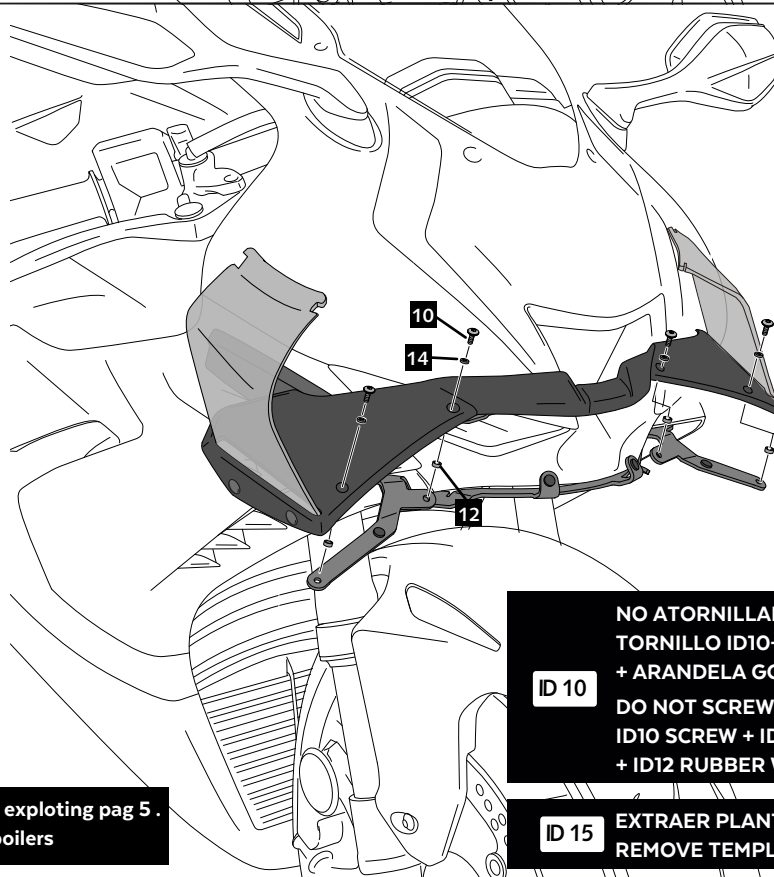

NO ATORNILLAR, SÓLO REALIZAR PREMONTAJE:
TORNILLO ID10+ ARANDELA NYLON ID14
+ ARANDELA GOMA ID12

ID10

DO NOT SCREW, ONLY PERFORM PRE-ASSEMBLY:
ID10 SCREW + ID14 NYLON WASHER
+ ID12 RUBBER WASHER

ID15

EXTRAER PLANTILLA ANTES DE MONTAR EL ALERÓN.
REMOVE TEMPLATE BEFORE ASSEMBLY THE SPOILER



Para montaje alerones ver exploding pag 5.
See page 5 to assembly spoilers

HONDA CBR1000RR FIREBLADE / SP '20-

INSTRUCCIONES DE MONTAJE - MOUNTING INSTRUCTIONS - MONTAGEANLEITUNG

7

**ASSEMBLY
MONTAJE**

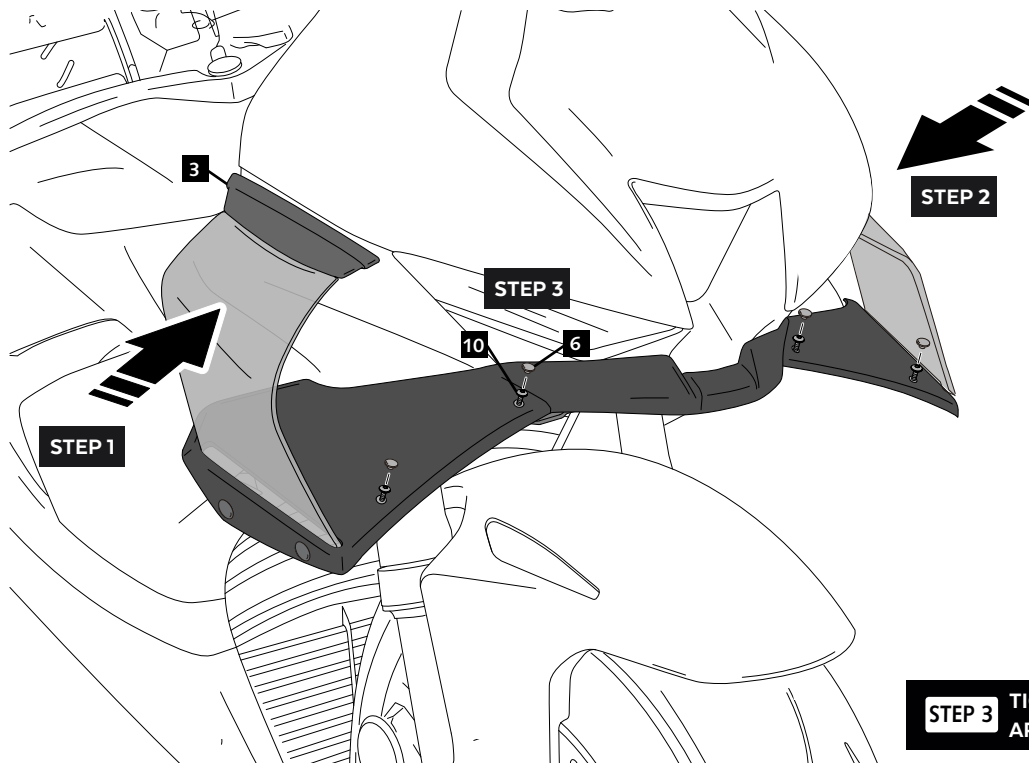

**EXPLOTING
DESPIECE**

