



Thank you for purchasing a National Cycle product. Read these instructions carefully and thoroughly before beginning work. Dealers, if installing this windscreen for a customer, please give them this manual. It contains information needed to properly maintain and use this product.



Attention:

Special notes and cautionary measures which can prevent damage to the accessory or motorcycle.



Note:

Tips for facilitation of operation, control and adjustment, as well as maintenance work.

CONTENTS OF KIT

Item	Description	Part No.	Qty.	Notes and Tools
1	VStream® Windscreen		1	All Stock Hardware Will Be Re-used

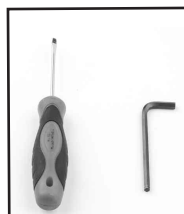
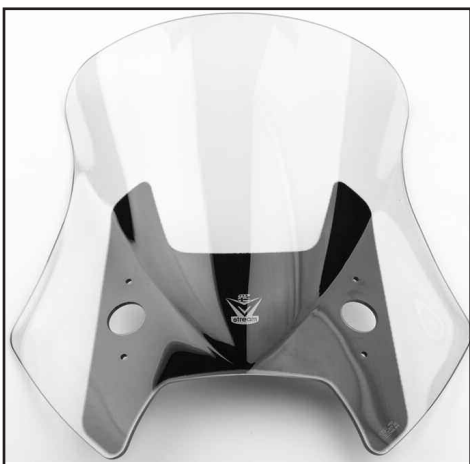

TOOLS

- Small Flat Blade Screwdriver
- 5mm Hex Key
- Tape (Optional)

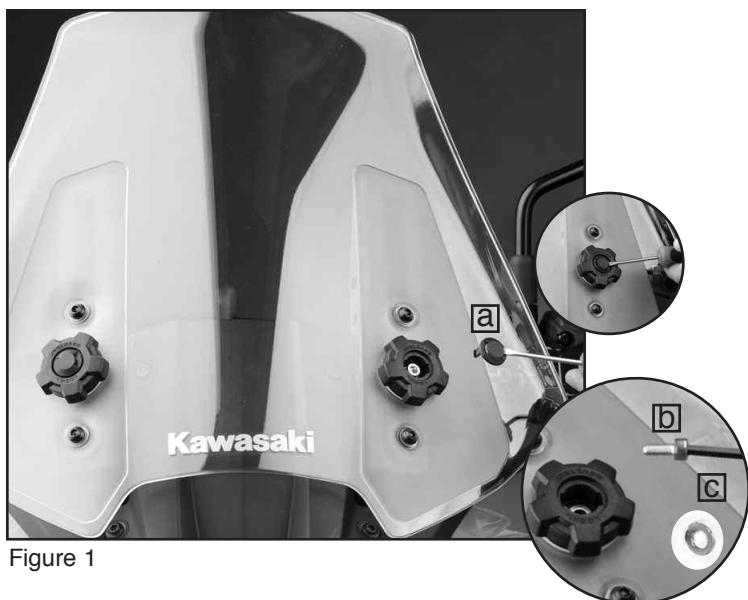

Figure 1

PREPARATION

1. Place motorcycle securely on its side stand.
2. Remove the 2, Caps (a) Screws (b) and Washers (c) holding the Adjustment Knobs in place. (Flat Blade Screwdriver, 5mm Hex Key) Figure 1



All stock hardware will be reused.

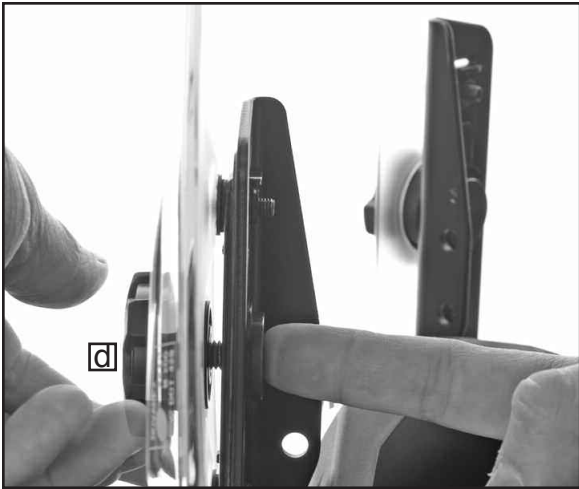

Figure 2

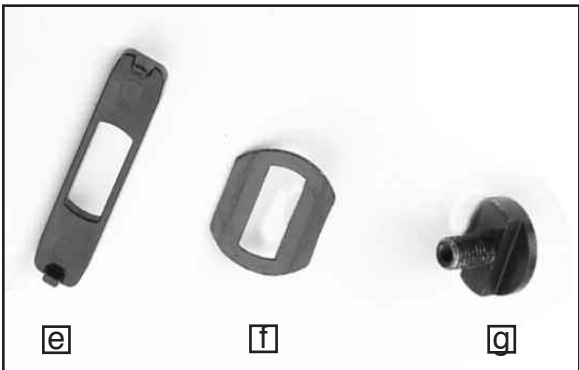

Figure 3



Figure 4

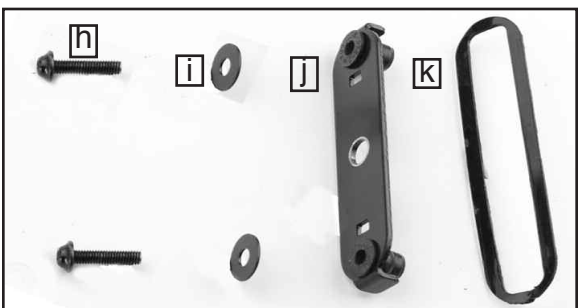

Figure 5

PREPARATION

3. Remove the stock Adjustment Knob (d) from front of stock Windscreen. Removal of Knob will release parts (e, f, and g). Repeat on opposite side. **Figures 2 and 3**

 **All stock hardware will be reused.**

 **Note, the Upper Hex Screw is a longer length than the lower.**

4. Remove the 4, front Hex Screws from Stock Windscreen. Removal of Screws will release parts (h, i, j and k). **(5mm Hex Key) Figures 4 and 5**

 **All stock hardware will be reused.**

INSTALLATION

1. Install Stock Parts (h, i, j and k) to the VStream Windshield. *Install longer Hex Screws at upper locations. (5mm Hex Key) Figure 6*

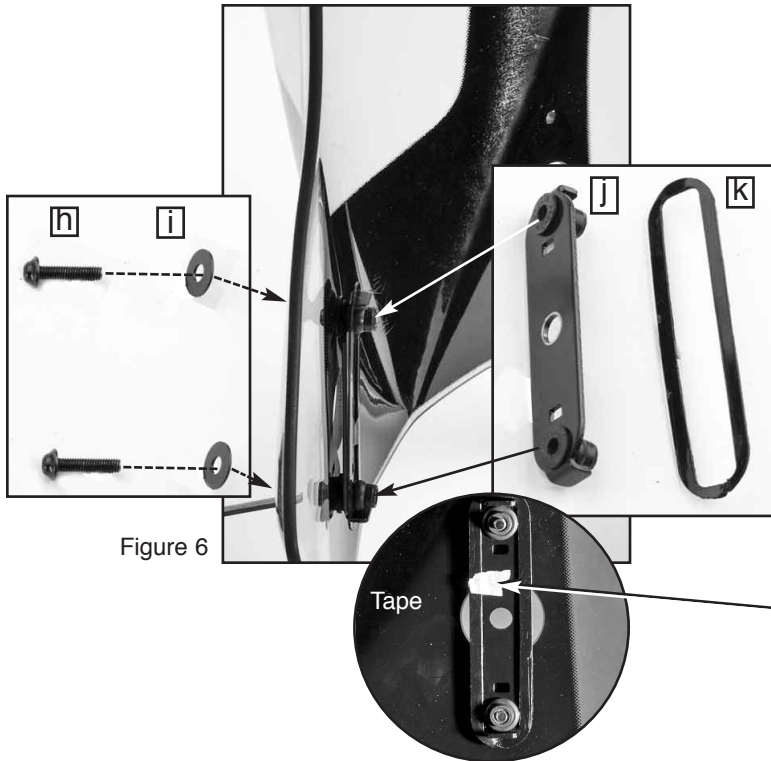

Figure 6

It will be helpful to hold stock part (k) in place with a small piece of Tape while completing installation. (Masking Tape) Figure 6 inset

Installation of VStream Windscreen should be done with the windshield adjustment in the *lowest* position.

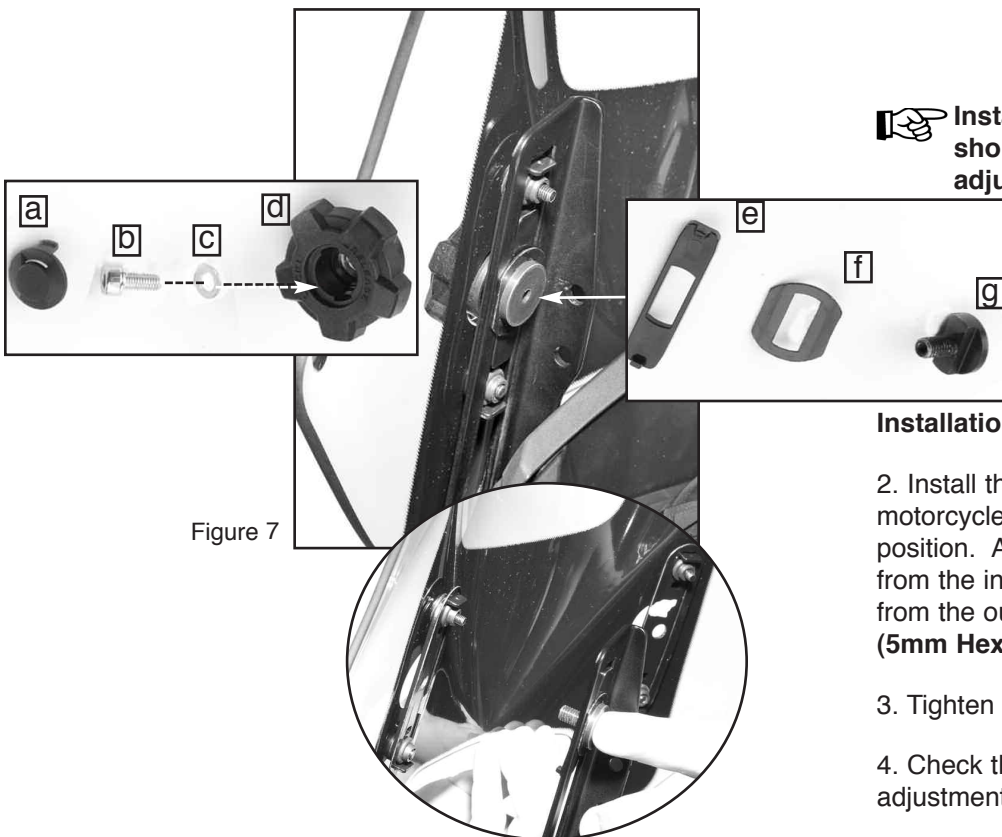

Figure 7

Installation of VStream Windscreen

2. Install the VStream Windscreen to the motorcycle's windshield bracket in the lowest position. Assemble stock parts (e, f, and g) from the inside of Windshield and (b, c, and d) from the outside. Repeat on opposite side. (5mm Hex Key) Figure 7

3. Tighten Screws firmly. (5mm Hex Key)

4. Check the operation of the windscreen adjustment.

5. Install Caps (a).



Figure 8

Finished Installation, Figure 8

Enjoy your new VStream® Windshield



CLEANING AND MAINTENANCE To clean the screen, wash with a clean soft cloth, plenty of warm water and if necessary, a non-abrasive soap such as dishwashing liquid. Flannel or soft chamois make good cleaning cloths. **Paint, glue residue or grease removal:** Moisten cotton with naphtha or turpentine followed by a wash as above. National Cycle **Shield Wash™** (N1401-01) makes a good daily cleaner and comes with a handy travel size bottle. Shield Wash is safe for all windshields and helmet visors.

Do not clean polycarbonate in hot sun or high temperatures. Do not clean the screen with glass cleaners.

Do not allow brake fluid, alcohol, or strong solvents to contact the screen.

RAIN REPELLENT Do not use rain protective products made for glass. We recommend National Cycle's **RainZip®** (N1410-01) to keep your windscreen clear in rainy weather.

WARNING

Fahren Sie Ihr Motorrad niemals mit losen Zubehörteilen. Überprüfen Sie die Halterungen regelmäßig auf festen Sitz.

Die heutigen Motorräder sind mit einer ausreichenden Rahmensteifigkeit gebaut, um den moderaten Belastungen standzuhalten, die durch die absehbare Hinzufügung eines oder mehrerer Zubehörteile auf sie ausgeübt werden. Wenn ein oder mehrere Zubehörteile die Stabilität Ihres Motorrads beeinträchtigen, entfernen Sie sofort das / die Zubehörteil (e). Nehmen Sie kein Motorrad in Betrieb, das unsichere Fahreigenschaften aufweist.

Lassen Sie das Problem von erfahrenem Servicepersonal beheben, bevor Sie mit installiertem Zubehör fahren. Bei weiteren Fragen zu Handhabungsproblemen im Zusammenhang mit einem oder mehreren Zubehörteilen wenden Sie sich bitte an Ihren Händler, Motorradhersteller oder Zubehörhersteller.

Sonnenlicht, das von der inneren Krümmung der Windschutzscheibe reflektiert wird, kann zu bestimmten Tageszeiten zu einem extremen Wärmestau auf den Instrumenten des Motorrads führen und diese möglicherweise sogar zum Schmelzen bringen. Gehen Sie beim Parken vorsichtig vor, um dies zu vermeiden. Stellen Sie Ihr Motorrad in Richtung Sonne ab oder platzieren Sie einen undurchsichtigen Gegenstand über diesem Bereich.

VStream® windshield patent no. 7,387,328

National Cycle, Inc. PO Box 158 Maywood, IL 60153-0158 USA

708-343-0400 / Fax: 708-343-0625 / www.nationalcycle.com / e-mail: info@nationalcycle.com